

Services Menu - Series 'K' Mortise Lock Case Handing / Backset changing

Part I - K760 70mm backset parts Illustrated

Part II - Instruction for Hand Change

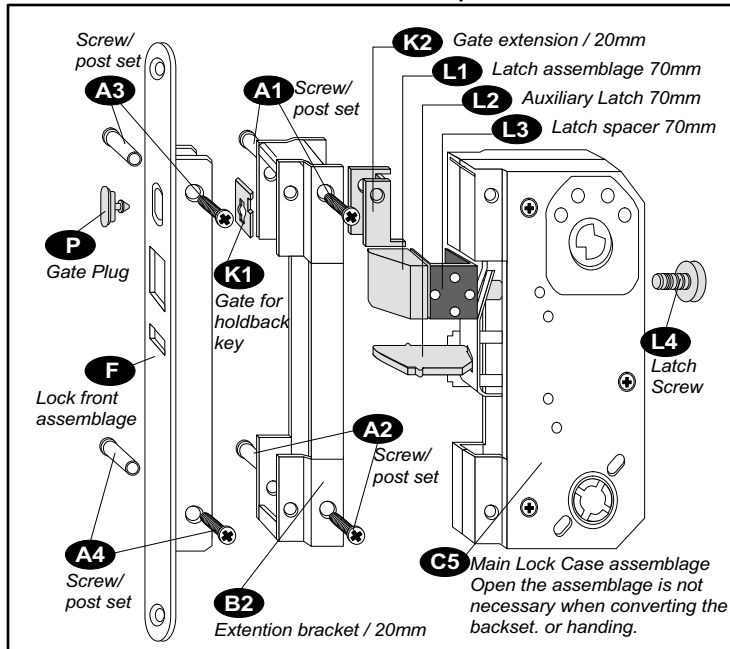

- Open the main Lock Case Assemblage C5 is not necessary to do the hand change. Please read carefully the steps followed prior to disassemble the lock case.

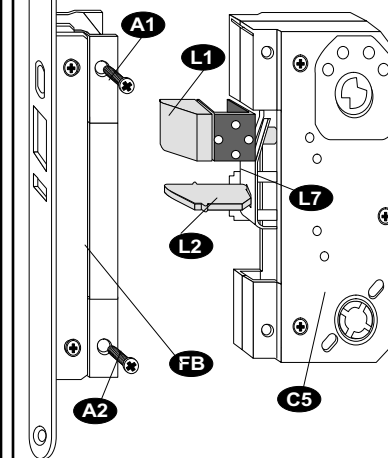

- Step 1 - Disassemble the **Lock front / Extension Bracket FB** from the **Main Lock Case Assemblage C5** by removing **Screw/Post set A1 and A2**
- Step 2 - Rotate the **Latch L1** for 180 degree
- Step 3 - Lean backward the **Auxiliary Latch L2** and remove. Rotate 180 degree and snap back to the **Auxiliary Rod L7**
- Step 4 - Engage the **Lock Front/Extension Bracket assemblage FB** to the **Main Lock Case Assemblage C5** and fasten the **Screw/Post A1 + A2**.

Part III - Instruction for Backset converting - from 70mm to 50mm

Baton K series mortise lock case is designed for easy converting the backset, without disassembling / open the main Lock Case Assemblage. Please read carefully the steps followed prior to disassemble the lock case.

